



## Rigid Panel Safety Information

**Installation of rigid panels should only be performed by a licensed professional.** Failure to properly and securely install tambour panels may result in avoidable damage or serious injury. It is recommended all installation work be done by at least two people for ease and accuracy. Always wear personal protective equipment when performing installation. Read through all instructions prior to the assembly and installation process. Please contact us at 800-328-5858 with any questions.

Properly installed panels should be able to remain on the surface it is attached to without any sort of loosening or unforced removal. **NEVER** install panels onto a ceiling or horizontal surface. Tambour designed to installed vertically only.

### When installing rigid panels, be sure to perform each of the following tasks thoroughly:

- Assure all adhesives and fasteners have adhered or attached to the surface you're applying the panels to.
- Wear the appropriate personal protective equipment (not included) as you perform each task. **NEVER** allow yourself to be caught off guard by potential accidents.
- Read instructions all the way through prior to installing. Familiarize yourself with each step prior to actual installation and seek clarification if necessary.
- Assure your work area is clean and free of debris and potential obstacles.
- Clean both the backing of tambour and the surface you're attaching the panels to – free them of dust, dirt, moisture and debris.

### **Proposition 65 for Wood Products**

Rigid Panels are made from raw wood which may contain traces of wood dust on its surface – which may become airborne during handling. Likewise, any alteration to the tambour (sanding, sawing, etc.) may cause wood dust to be generated.

**WARNING:** Drilling, sawing, sanding or machining wood products can expose you to wood dust, a substance known to the State of California to cause cancer. Avoid inhaling wood dust or use a dust mask or other safeguards for personal protection. For more information go to [www.P65Warnings.ca.gov/wood](http://www.P65Warnings.ca.gov/wood).

## Rigid Panel Installation

**IMPORTANT:** Installation of tambour should only be performed by a licensed professional. Failure to properly and securely install tambour panels may result in avoidable damage or serious injury. It is recommended all installation work be done by at least two people for ease and accuracy. Always wear personal protective equipment when performing installation. Read through all instructions prior to the assembly and installation process. Please contact us at 800-328-5858 with any questions. Properly installed tambour should be able to remain on the surface it is attached to without any sort of loosening or unforced removal. NEVER install tambour onto a ceiling or horizontal surface. **Tambour designed to installed vertically only.**

**Required Tools:** Tape measure, table saw, pencil, low-grit sand paper, construction adhesive or nailing tools.

### Step #1:

Measure the surface the tambour will be installed onto. The measurements you find here will ultimately be the size the cut-down tambour panel will need to be.

### Step #2:

Using a pencil, mark the measurements on the tambour piece you're cutting.

*Be sure to compensate for any pattern symmetry to assure your final panel is to the look you prefer. If you plan measurements run a little bigger than what is actually necessary - it should be OK as trimming can be done.*

Step #1:

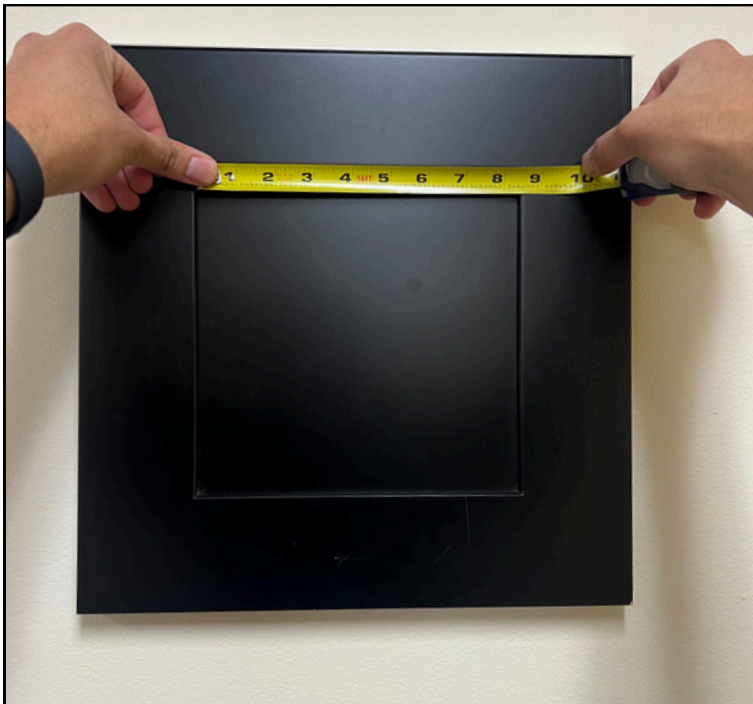

Step #2





## Solid Tambour Installation

### Step #3:

Using a table saw, cut the panel to the planned dimensions. Once cutting is down, carefully sand the cut edges of the panel with a low-grit sand paper to remove an excess hanging bits of material. **DO NOT over sand.** This may cause your dimensions to be off and can compromise the appearance of the panel.

*Using a miter saw may be used for cuts going against the grain of the panel, but they should not be used for cutting with the grain. Most common miter saws may also be limited in size for the length of appropriate cuts.*

### Step #4:

Confirm the size of the panel with the size of the area it will be attached. It should fit flush with the area you're applying it. If the panel is too big, perform the appropriate cuts to make it fit.

*If you cut/sand the panel to a size that's too small, you will need to start fresh with a new panel.*

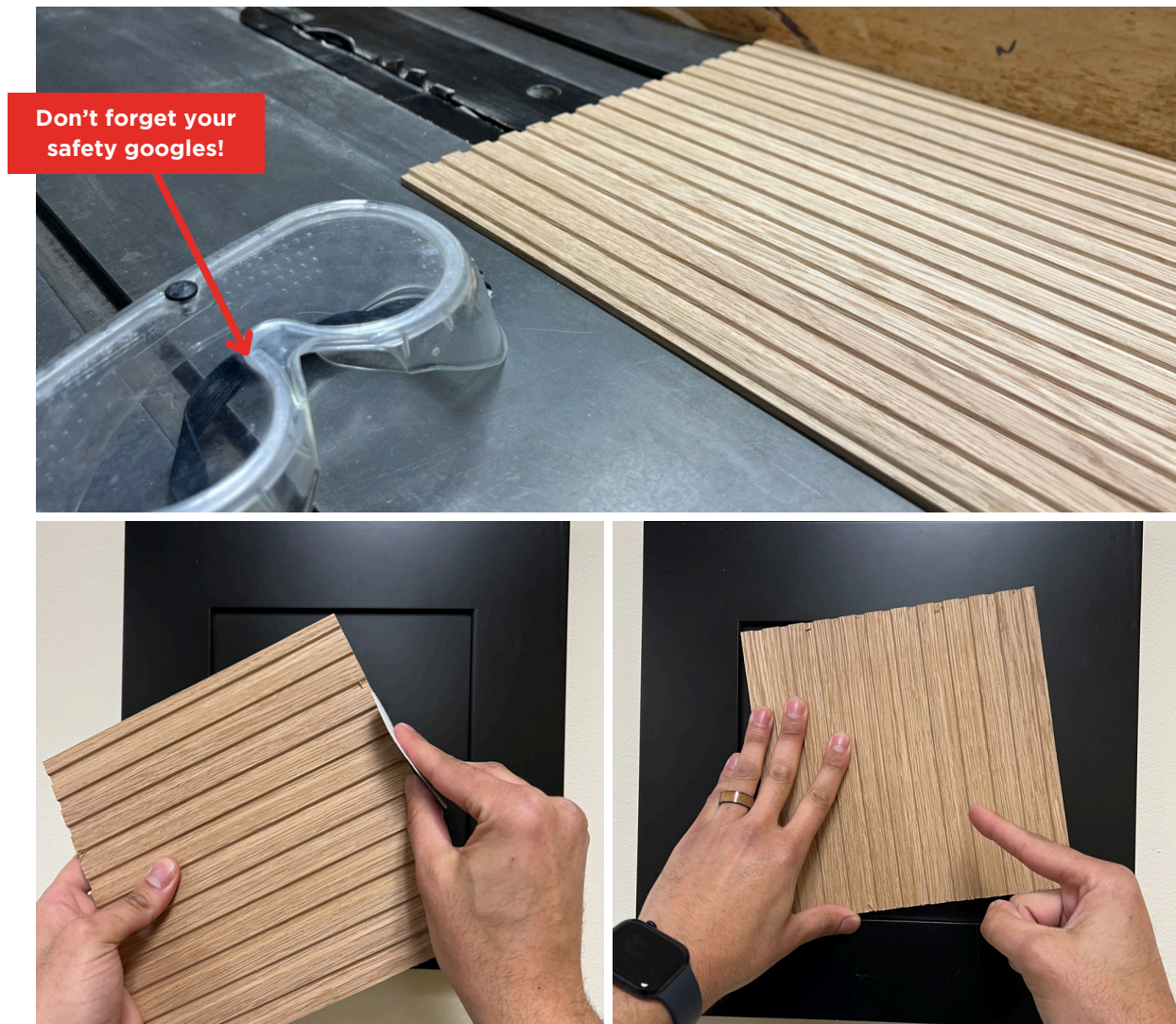

## Solid Tambour Installation

### Step #5:

Using a cloth, wipe the surface you'll be attaching the panel to. Likewise, wipe the back of the tambour panel. This is in order to remove an excess dust or debris.

*Without wiping, the surfaces may retain some debris, which could compromise the hold of adhesive.*



### If using construction adhesive:

#### Step #6:

Apply adhesive to the back of the panel. This is best done in lines of adhesive the length of the panel. Placing the lines approximately 3"-4" apart from each other. Once the adhesive is applied, use an adhesive spreader to spread the glue liberally across the back of the panel. Getting full coverage on the panel is most effective.

*Be sure these steps are being performed in an open, well-ventilated environment. The adhesive may be harmful if fresh air is not allowed to flow through.*

#### Step #7:

Apply the glue-covered back of the panel to the surface it's being attached too. If any glue seeps out, carefully and promptly wipe it with a rag.

#### Step #8:

Hold the now-glue panel in place to allow the adhesive to dry. This can be done by placing weight atop the panel or using carefully placed clamps.

#### Step #9:

Once the adhesive has dried, the panel is now fully attached. There may be some post-work cleanup required - like cleaning excess glue that may have seeped through.





### If using finishing nails:

#### Step #6:

Place the panel in the area you wish to install it. Assure the panel is exactly where it should be when it is done. Use a clamp to hold it in place if needed.

*Adhesive can be used in combination with finishing nails in certain applications. See steps of "If using construction adhesive" for more information.*

#### Step #7:

Select the proper size finishing nail. Finishing nails should be long enough to penetrate the panel completely and go as deep into the attached surface as possible.

*Appropriate nail size will always vary depending on the application, material and setting. Using nails that are too small may cause the integrity of the fastening to be compromised. Using nails that are too big may cause damage to the panel and surface.*



#### Step #8:

Once nail size is selected, pick the location of nail penetration. Using either a hammer or a pre-loaded nail gun, insert the nail into the panel and backing surface. Do this repeatedly for every desired spot of penetration.

#### Step #9:

The nail installation may cause some residual tearing and some small pieces of material may hang off the surface of the panel. These can be removed with simple sanding.



### Storage and Pre-Installation

Hardwood Rigid Panels should be allowed to acclimate to the environment it will be installed in (like all raw hardwoods) for 2-3 days prior to finishing while STILL in its original packaging. The environment should be minimal in humidity and temperate in climate. Rigid Panels should be finished within 24 hours of unpackaging to assure moisture and particulates do not affect the surface. Panels should be inspected once received and allowed to remain within its packaging up until finishing. Never store panels near a direct heat source, open window, ventilation openings or any other source that may impact the area. \*

### Treating

Hardwood Panels, like all raw hardwood components, should be coated in a sealant prior to project completion. This is in order to maintain the wood's quality of color, applied paint/stain and surface integrity. Use of oil or lacquer-based sealants is not recommended on flexible panels as this may compromise the strength of both the wood and flexible backer. Water-based sealants can be used in for these applications. \*

### Maintenance

Once sealant has been applied, Hardwood Panels can be maintained with regular cleaning and conditioning. To clean sealed tambour surfaces, use a damp cotton cloth and use long, consistent streaks for best results. For tougher stains, warm water and simple soap can be used. It is recommended all liquid spills onto a sealed panel surface be cleaned and dried immediately to avoid damage to the sealant or wood. \*

*\*Once Panels have been stored, sealed and/or installed by the purchaser, Brown Wood, Inc.® no longer assumes warranty over the product - meaning any cracking, discoloration, peeling warping, installation failure, etc. are not covered by our warranty terms. Always assure condition of tambour as soon as it's delivered.*