

## Step #1:

Determine desired height from floor to top of shelf.

Example: 65"

## Step #2:

Subtract thickness of shelf. Example: 3/4"

## Step #3:

Subtract the distance from the top of the corbel to the top of the key hole on back of corbel. This information can be found on the PDF drawing. Download PDF drawings from the product page on our website. Example: 2.188"

## Step #4:

Measure down to the top of the bottom key home.

Example: 3.25"

## Step #5:

Screw into the wall. It is recommended to screw directly into studs (see [here](#) for instructions on how to locate studs). Leave .25" revealed for corbel keyholes.

## Step #6:

Place corbel keyholes onto screws and push corbel down until it engages the narrow section of the keyhole, ensuring it's completely seated.



Step #1

Step #2

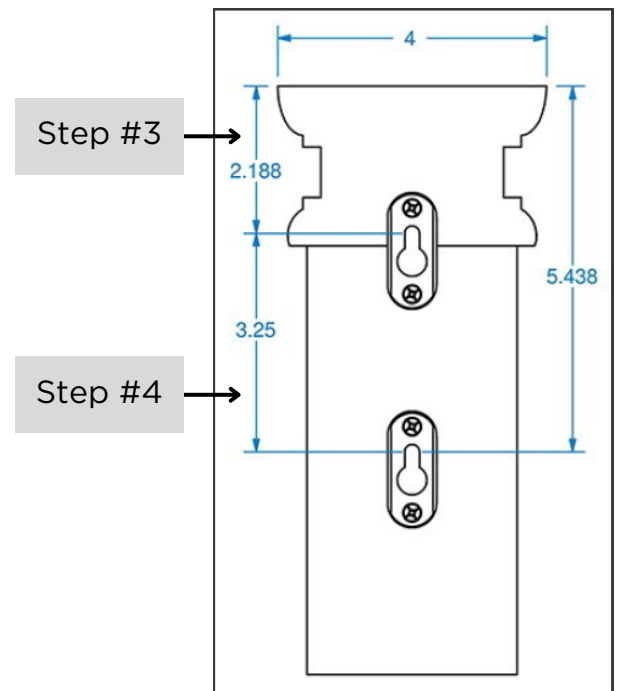

Step #3

Step #4

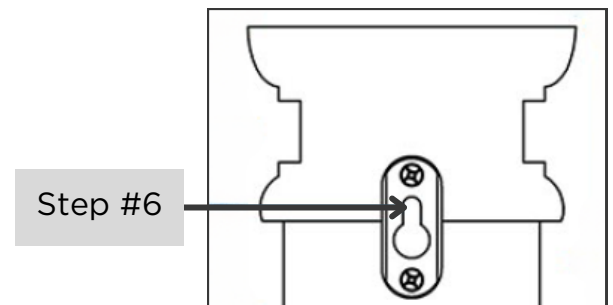

Step #6

